

### 8.1 - Header bracket fixing

### INSTALLATION

The header bracket is fixed to the door frame in the centre of the opening. It must be set high enough for the door not to interfere with the rail throughout the door's travel.

The bracket height depends on the door thickness and door roller design. Open the door to check the highest point that the door edge reaches. The highest point is usually when the door is half open.

Mark hole centres, then mount the bracket with four suitable fixings.

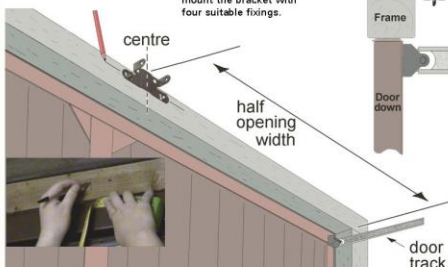

The header bracket's lower slotted mounting holes must be at least 10mm above the highest point the door reaches. The slotted holes can be set 200mm higher if you prefer, but over 50mm from the ceiling.

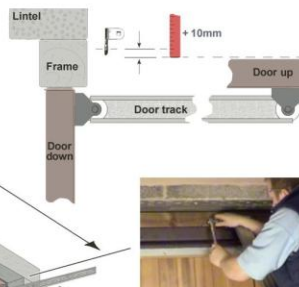

### 8.2 - Door bracket fixing

The door bracket fixes to the centre of the door below the header bracket. It requires a strong fixing, so choose a structural member of the door.



Height is not critical, but should be within 150mm of the top of the door.

The full force of the opener will be pulling on this bracket. Bolting through the door is best, with the nuts on the inside. Coach bolts have plain heads that cannot be tampered with from outside.

Find the 8mm cotter pin, its split pin, and the 'J' bar.



Fit the 'J' bar to the door bracket with the 8mm cotter pin. Insert the split pin, then bend out one leg of the split pin to secure it.

### 8.3 - Lifting the rail

You will need a step ladder for the next stage. Lean the opener against the door frame with the motor head resting on a polystyrene box for protection.

Fix the rail end to the header bracket with the long bolt. The bracket has a square hole and a round hole. Insert the bolt thru the

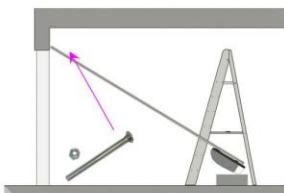

Lift the head up onto the steps until the rail is horizontal. Place the steps so that the opener's rail is parallel with the garage door guides.

The opener is now in the right position. Open and close the door to check there are no points of conflict.

### 8.4 - Fixing rail brackets

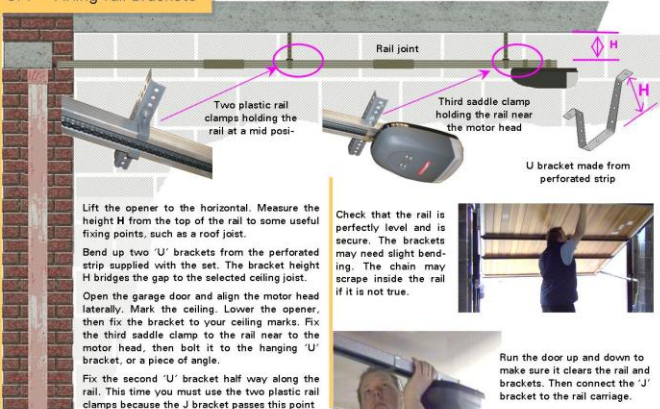

Lift the opener to the horizontal. Measure the height H from the top of the rail to some useful fixing points, such as a roof joist.

Bend up two 'U' brackets from the perforated strip supplied with the set. The bracket height H bridges the gap to the selected ceiling joist.

Open the garage door and align the motor head laterally. Mark the ceiling. Lower the opener, then fix the bracket to your ceiling marks. Fix the third saddle clamp to the rail near to the motor head, then bolt it to the hanging 'U' bracket, or a piece of angle.

Fix the second 'U' bracket half way along the rail. This time you must use the two plastic rail clamps because the J bracket passes this point

Check that the rail is perfectly level and is secure. The brackets may need slight bending. The chain may scrape inside the rail if it is not true.



Run the door up and down to make sure it clears the rail and brackets. Then connect the 'J' bracket to the rail carriage.

The opener installation is now complete.

### 8.5 - Electrical

The opener is pre-wired with a UK plug. Have a qualified electrician install a 13A mains socket within 1m of the motor.

On power up, the courtesy light will come on and the motor will beep. The display will show a circulating pattern of LEDs.

